

**ORDER OF BOARD OF SUPERVISORS** Madison **COUNTY,**  
**SETTING FORTH PROPOSED STATE AID PROJECTS FOR**  
**PERIOD** January 1, 2016 **THROUGH** December 31, 2019

Pursuant to the provisions of Senate Bill No. 1 of the Extraordinary Session of 1949 and as subsequently amended, herein after referred to as said Act, We, the undersigned members of the Board of Supervisors of Madison County, hereby order that the proposed project(s) listed herein constitute the State Aid Program for Madison County for the period January 1, 2016 through December 31, 2019.

In support of this order, the Board certifies and agrees that:

1. The State Aid System in said County has been designated by the Board and approved by the State Aid Engineer, as required by said Act.
2. The Board has employed a Registered Professional Engineer as County Engineer, who will employ such other competent technical assistant(s), as required, to properly supervise and inspect the work in compliance with the Rules and Regulations of the State Aid Engineer, all as required in said Act.
3. This program, which has been prepared by the County Engineer and approved by this Board, is herewith submitted to the State Aid Engineer for approval.
4. The Board will comply with all applicable Laws, Rules and Regulations in the acquisition of rights-of-way and will maintain the acquired rights-of-way for said project(s) to keep the same free of encroachments such as buildings, fences or any other obstructions. The Board designates Katie Bryant Snell as its right-of-way acquisition agent for the project(s) herein. The agent's address and phone number is 741 Avignon Drive, Suite A, Ridgeland, MS 39157 phone 601-460-9800.
5. Counties receiving \$500,000 or more in Federal funds from all projects constructed or being constructed in a Federal Fiscal Year (October 1 - September 30), must have a single audit conducted in accordance with OMB circular A-133.
6. The Board herein affirms its acceptance of the Office of State Aid Road Construction's policy for the accommodation of utilities as stated in S.O.P. No. SA II-2-8 and agrees to coordinate utility facility installation and/or adjustment in a timely manner so as not to impede project development.
7. The Board will maintain the project(s), after completion, in a regular and satisfactory manner subject to the approval of the State Aid Engineer, all as required in said Act.
8. The State Aid Engineer is authorized to effect such transfer of funds as are necessary to pay engineering costs on the project(s), as authorized by Mississippi Code 1972, Section 65-9-15, and in accordance with the Rules and Regulations promulgated by the State Aid Engineer, dated July 1, 2005.
9. The State Aid Engineer is authorized to effect such transfer of funds as are necessary to pay testing expenses incurred PRIOR to the award of Contract on any project(s) included in this program. In the event the Board cancels or withdraws any project(s) included in this program, the Board hereby agrees to reimburse its State Aid Fund for testing charges incurred.

PROJECT PRIORITY NO. \_\_\_\_\_

1. Project No. SAP 45(13)M
2. Name of Road: Virillia Road
3. Design Classification: (check one) Rural  Urban \_\_\_\_\_ (check one) Collector  Local \_\_\_\_\_  
Federal Route Number 514
4. Termini of Project: BOP Persimmon Creek (S13, T9N, R1W)  
EOP Panther Creek (S13, T9N, R 1 E)  
Previous Projects S-514(2)1, SAP-45(40)
5. Length of Project: 6.8 Miles
6. Character of Work (Show Alternates if Applicable) Portions to reconstructed, overlay

7. Design Data:
  - a. Traffic Count: How Determined CMPDD  
Current ADT 210 VPD; Design Year ADT \_\_\_\_\_ VPD; %Trucks 4  
Traffic Count Required: Yes \_\_\_\_\_ No  (Attach Supplemental Sheet)
  - b. Terrain Level  Rolling \_\_\_\_\_ Design Speed 40 MPH
  - c. ROW: Existing 60 Ft.; Proposed \_\_\_\_\_ Ft.
  - d. Proposed Roadway Crown Width 24-28 Ft.
  - e. Surface Type & Width: Existing HBSC, DBST 18 Ft.  
Proposed HBSC 18-20 Ft.

8. Bridges:
  - a. Str. No. \_\_\_\_\_ Suff. Rtg. \_\_\_\_\_ Capacity \_\_\_\_\_  
Remain in Place: Yes \_\_\_\_\_ No \_\_\_\_\_ Existing/Proposed Width \_\_\_\_\_ Ft.
  - b. Str. No. \_\_\_\_\_ Suff. Rtg. \_\_\_\_\_ Capacity \_\_\_\_\_  
Remain in Place: Yes \_\_\_\_\_ No \_\_\_\_\_ Existing/Proposed Width \_\_\_\_\_ Ft.
  - c. Str. No. \_\_\_\_\_ Suff. Rtg. \_\_\_\_\_ Capacity \_\_\_\_\_  
Remain in Place: Yes \_\_\_\_\_ No \_\_\_\_\_ Existing/Proposed Width \_\_\_\_\_ Ft.
  - d. Str. No. \_\_\_\_\_ Suff. Rtg. \_\_\_\_\_ Capacity \_\_\_\_\_  
Remain in Place: Yes \_\_\_\_\_ No \_\_\_\_\_ Existing/Proposed Width \_\_\_\_\_ Ft.
  - e. Str. No. \_\_\_\_\_ Suff. Rtg. \_\_\_\_\_ Capacity \_\_\_\_\_  
Remain in Place: Yes \_\_\_\_\_ No \_\_\_\_\_ Existing/Proposed Width \_\_\_\_\_ Ft.

9. Estimated Construction Cost of Project (Including Contingencies) \$	<u>2,790,900</u>
a. STP Funds Requested ( _____ %)	\$ _____
b. BR Funds Requested ( _____ %)	\$ _____
c. SA Funds Requested ( <u>100</u> %)	\$ <u>2,790,900</u>
d. LSBP Funds ( _____ %)	\$ _____
e. _____ Funds	\$ _____

Engineering Cost ( 12 %) (Constr. Cost Less Contingencies) \$ 318,960

a. State Aid Funds Requested	\$ <u>318,960</u>
b. County Funds Contributed	\$ _____
c. LSBP Funds Contributed	\$ _____
d. _____ Funds Contributed	\$ _____
Total Estimated Cost of Project	\$ <u>3,109,860</u>

Construction will be by: Contract  County Forces \_\_\_\_\_

Use Supplemental Sheet and/or maps if needed to provide complete data.

<b>FOR STATE AID USE ONLY:</b>		Preliminary Review _____	_____	Date
	Recommend Approval _____	_____	Dist. Engr.	_____
	Approved _____	_____	State Aid Engr.	_____
	Letter To Bd. _____	_____	Dist. Engr.	_____
	Funds Record _____	_____	Auditor	_____
	Programmed _____	_____	_____	_____

State Aid \_\_\_\_\_ Program for **Madison** \_\_\_\_\_ County

BOARD OF SUPERVISORS

\_\_\_\_\_, County  
\_\_\_\_\_, Supervisor, District I  
\_\_\_\_\_, Supervisor, District II  
\_\_\_\_\_, Supervisor, District III  
\_\_\_\_\_, Supervisor, District IV  
\_\_\_\_\_, Supervisor, District V

Prepared by:  \_\_\_\_\_, County Engineer

STATE OF MISSISSIPPI  
COUNTY OF **Madison** \_\_\_\_\_

This is to certify that the foregoing is a true and correct copy of an order passed by the Board of Supervisors of **Madison** County, Mississippi, entered into the minutes of the said Board of Supervisors, Minute Book No. \_\_\_\_\_, Page No. \_\_\_\_\_, same having been adopted at a meeting of said Board of Supervisors on the \_\_\_\_\_ day of \_\_\_\_\_, 2016.

\_\_\_\_\_  
Clerk of Board of Supervisors of  
**Madison** \_\_\_\_\_ County, Mississippi

**OFFICE OF STATE AID ROAD CONSTRUCTION  
MISSISSIPPI DEPARTMENT OF TRANSPORTATION  
JACKSON, MISSISSIPPI**

DATA TO BE SUBMITTED WITH ALL PROJECT PROGRAMS

Project Number SAP 45(13)M County Madison Date April, 2016

Road Connections at each End of Project  
West End, Surf. Type HBSC, DBST Surf. Width 18 Rdwy. Width 24  
 (South or West)  
East End, Surf. Type HBSC, DBST Surf. Width 18 Rdwy. Width 24  
 (North or East)

Railroad Grade Crossing Data  
 Is there an existing Railroad Grade Crossing? Yes  No

Name of Railroad N/A

Existing Protection \_\_\_\_\_

Proposed Protection \_\_\_\_\_

Existing and/or Proposed Facilities Effecting Route:

SCHOOLS: YES  NO  ON ROUTE  OFF ROUTE   
 INDUSTRY: YES  NO  ON ROUTE  OFF ROUTE

TYPE OF INDUSTRY: N/A

OTHER DESIGN CONSIDERATIONS: \_\_\_\_\_  
 \_\_\_\_\_  
 \_\_\_\_\_

UTILITY COMPANIES TO BE AFFECTED BY PROJECT:

NAME	STREET OR P.O. BOX ADDRESS	CITY
<b>Unknown</b>		

Signed   
 County Engineer

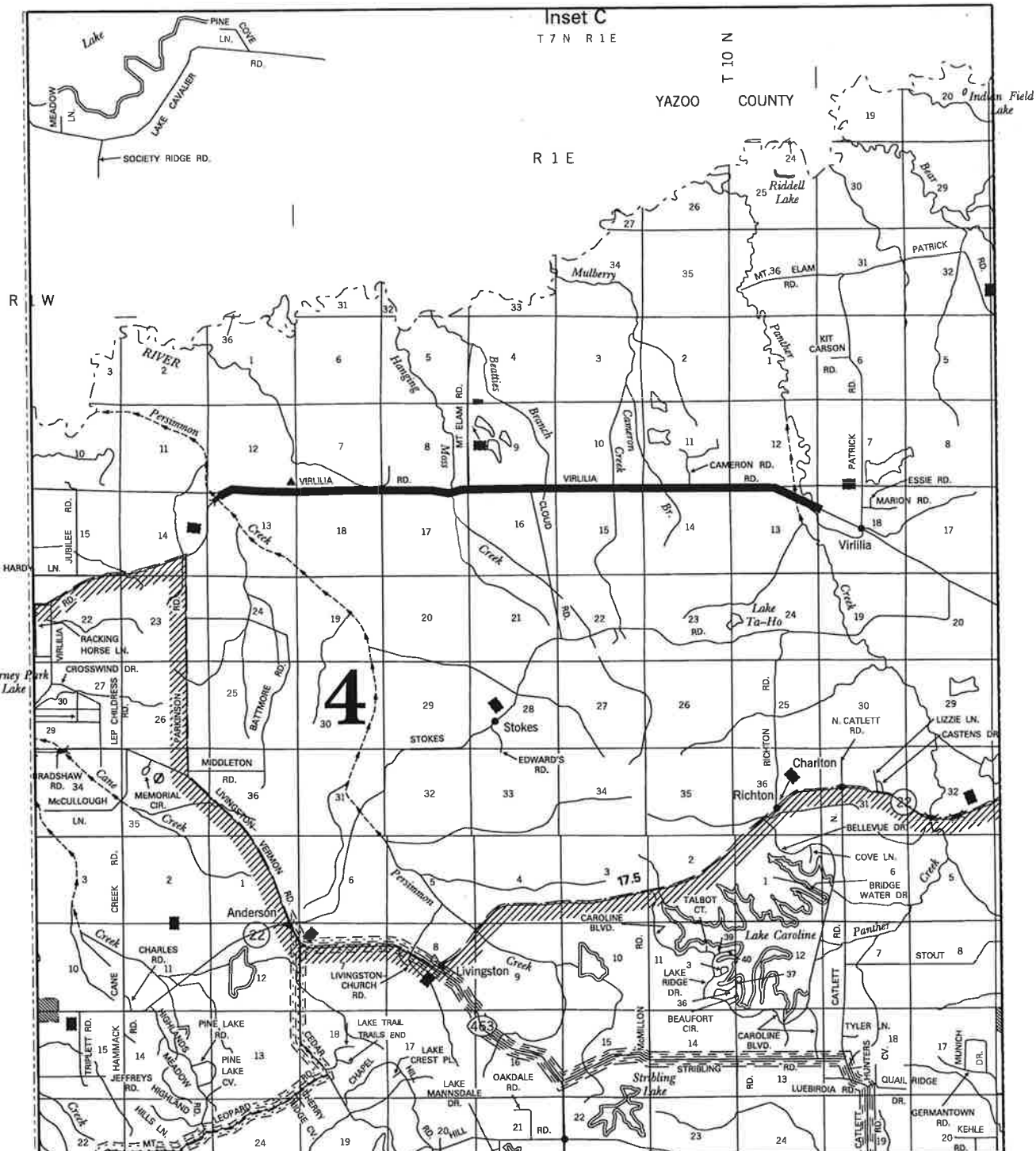

Inset C  
T 7 N R 1 E

YAZOO COUNTY

R 1 E

T 10 N

R 2 W

HARD LN.

4

LEGEND:  
PROJECT LOCATION   
ROADS 



VICINITY MAP



143-A LeFluors Square  
Jackson, MS, 39211  
(601) 355-9526

LOCATION MAP  
VIRILIA ROAD  
STATE AID PROJECT

DRAWING REVISIONS		
NO.	REMARKS	DATE

SHEET NUMBER:  
1 OF 1